

Living the dream

How to avoid the pitfalls of running a modern warehouse

John Hayward
Senior Consultant
Hatmill

Rubber walls - How do you store an ever growing range of products?



The Dream Warehouse – The Storage Solution

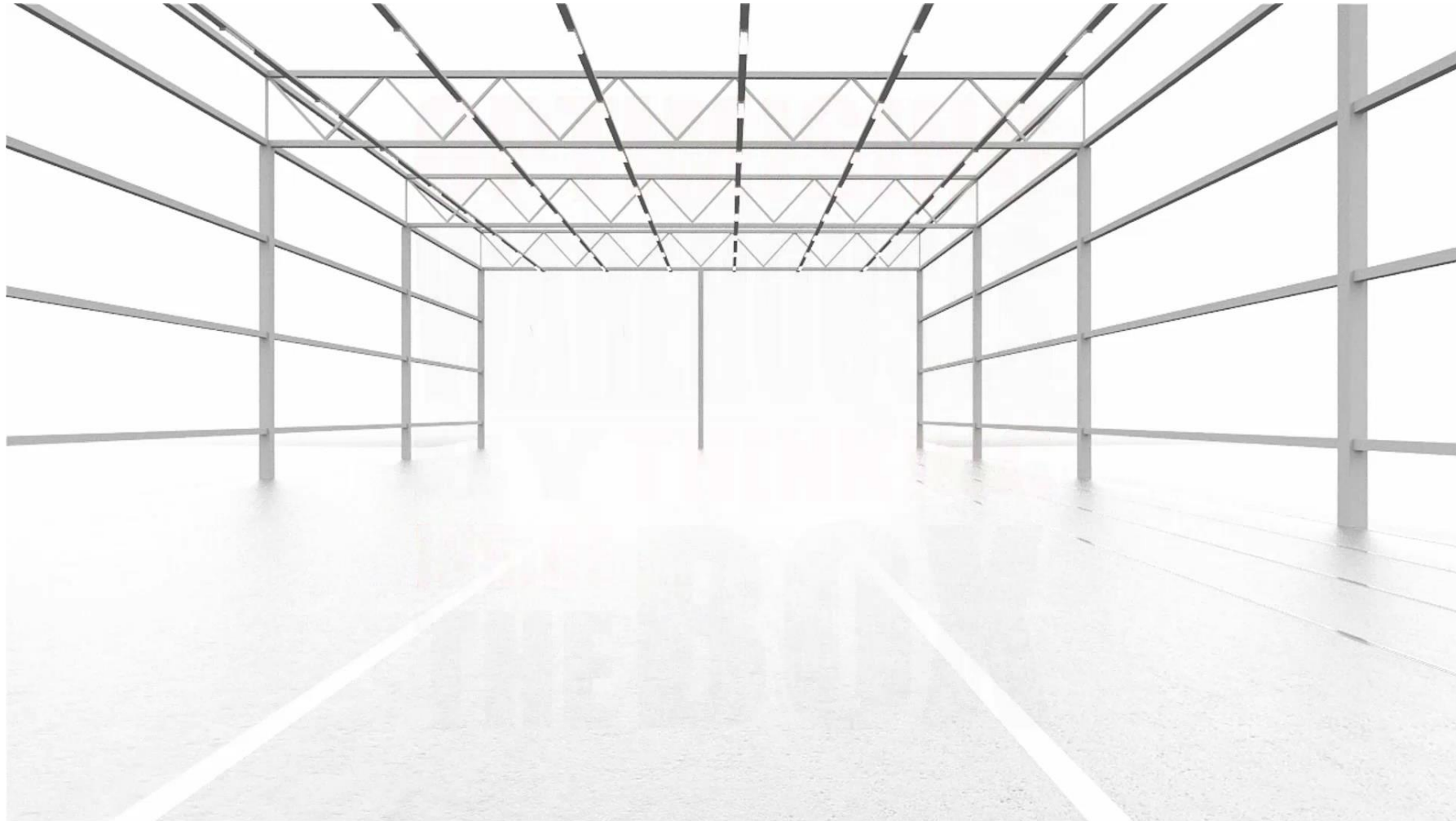

The Dream Warehouse – The Storage Solution

- **Does your storage provider understand your operation?**
- **A proficient storage provider can determine the best solution for you**
- **Simulations of various designs can be produced**
- **The warehouse plays a key role in your Supply Chain**
- **The wrong solution will cost the business money**

Example – understanding the right solution

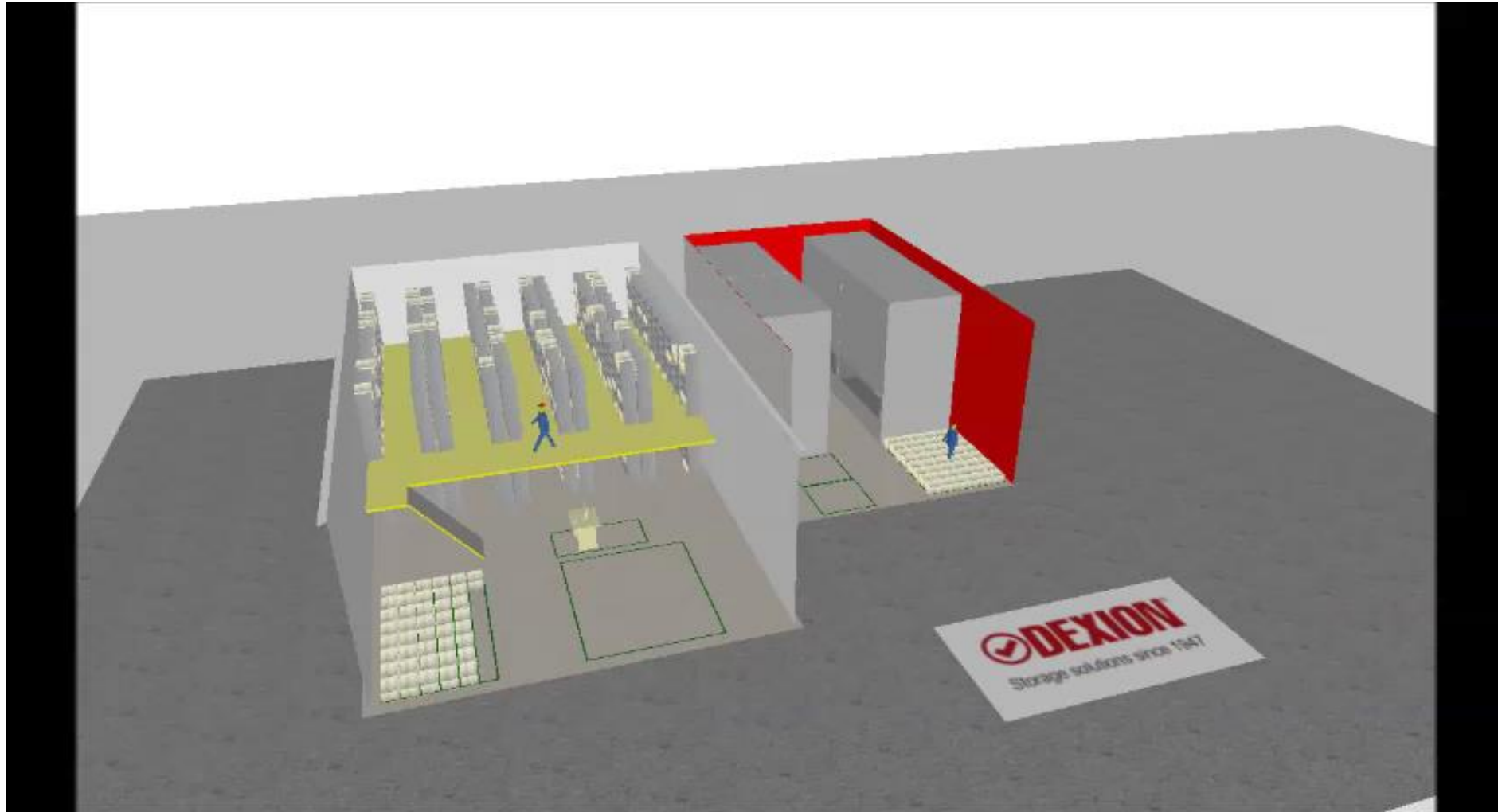

Example – understanding the right solution



The Dream Warehouse – The Storage Solution

- Take the time to talk to your storage provider
- Give them the remit and ask them to identify the solution / verify the proposal
- Simulations can be used to model proposed solutions
- There are many options in the market and one is sure to provide you with your:-

'DREAM WAREHOUSE'

Customisation of labelling requires an integrated approach to order processing and the routing requirements



Barry Day



**Telford Way, Colchester
Essex CO4 9QP**

Tel.01206 751300 Fax. 01206 751286

www.codeway.com

Getting the right item to the right customer

If the item cannot be identified how can it be picked / sent.

Correct identification may have been applied by the supplier.

If not part of the “goods in” procedure is to label / identify each item or

via a WMS system ensure that items are correctly loaded in storage areas.

Bar coding and 2D coding of items and locations speeds up processes and reduces errors.

Line of site technologies

1D bar codes



2D stacked / multi-line

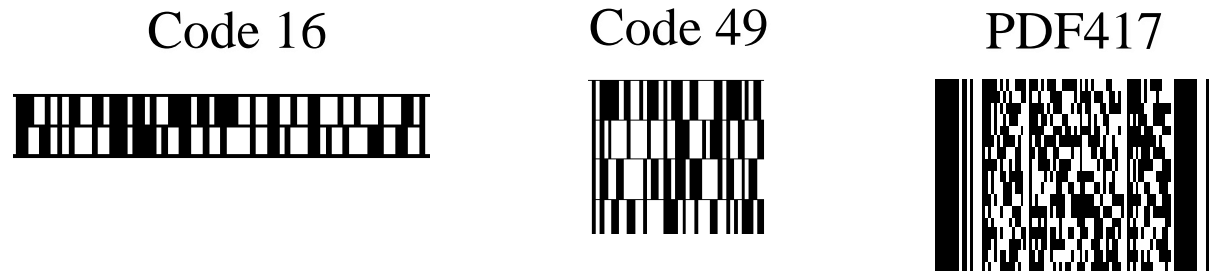

2D matrix

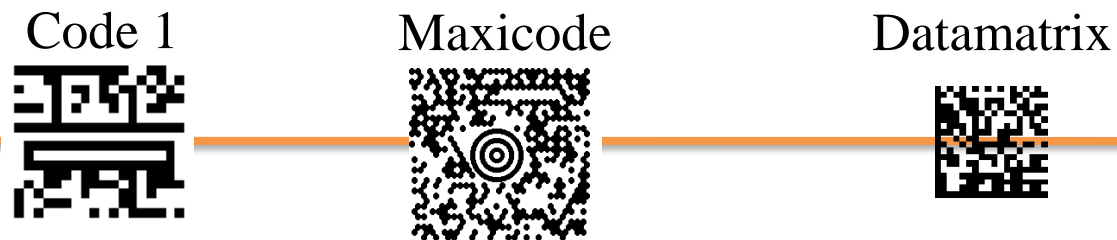

Identify the item

DATA OF BARCODE = UKBALL0000_bdl50

I am pretty sure that the barcode will not print without a white background and a slight white border around it. Therefore example 1 I do not think is an option.



1 ■

2 ■

3 ■

4 ■

16 alphanumeric

The correct destination

Once items are picked via:

- Portable data capture terminal
- Voice
- Pick by light

The next issue is to address correctly...

Portable printer – label at time of pick



QVC – scan item, integrate with order processing, print label, route the parcel



Order file sent to a print queue



GS1 identification



“Flash” labelling



Complete automated line





Identify

Track

Control

Data, data and more data – how to know when to implement automation and do it properly



Knapp – Dream Warehouse



Challenges

- Modular and expandable
- Reduce labour
- Efficient and ergonomic in all processes
- Flexibility in order to react to seasonal fluctuations
- Compatible with different business channels within a warehouse - BB, BC, e commerce
- Safe

Choices

- Racking – APR, Drive In, Narrow Aisle, Live Storage
- Transporting – FLT, ASRS, Shuttle,
- Conveyor – Belt, Roller, Zero Line Pressure
- Picking – Standard shelving, Longspan, CLS, Voice Pick, Vision Pick
- Sortation – Tilt Tray, Shoe, Cross Belt, Bomb Bay
- Software – WCS, WMS, Barcoding, Labelling,

Wrong decisions

NIGHTMARE

Right decision = dream warehouse



WMS implementations must be considered holistically not just as a quick fix to underlying problems



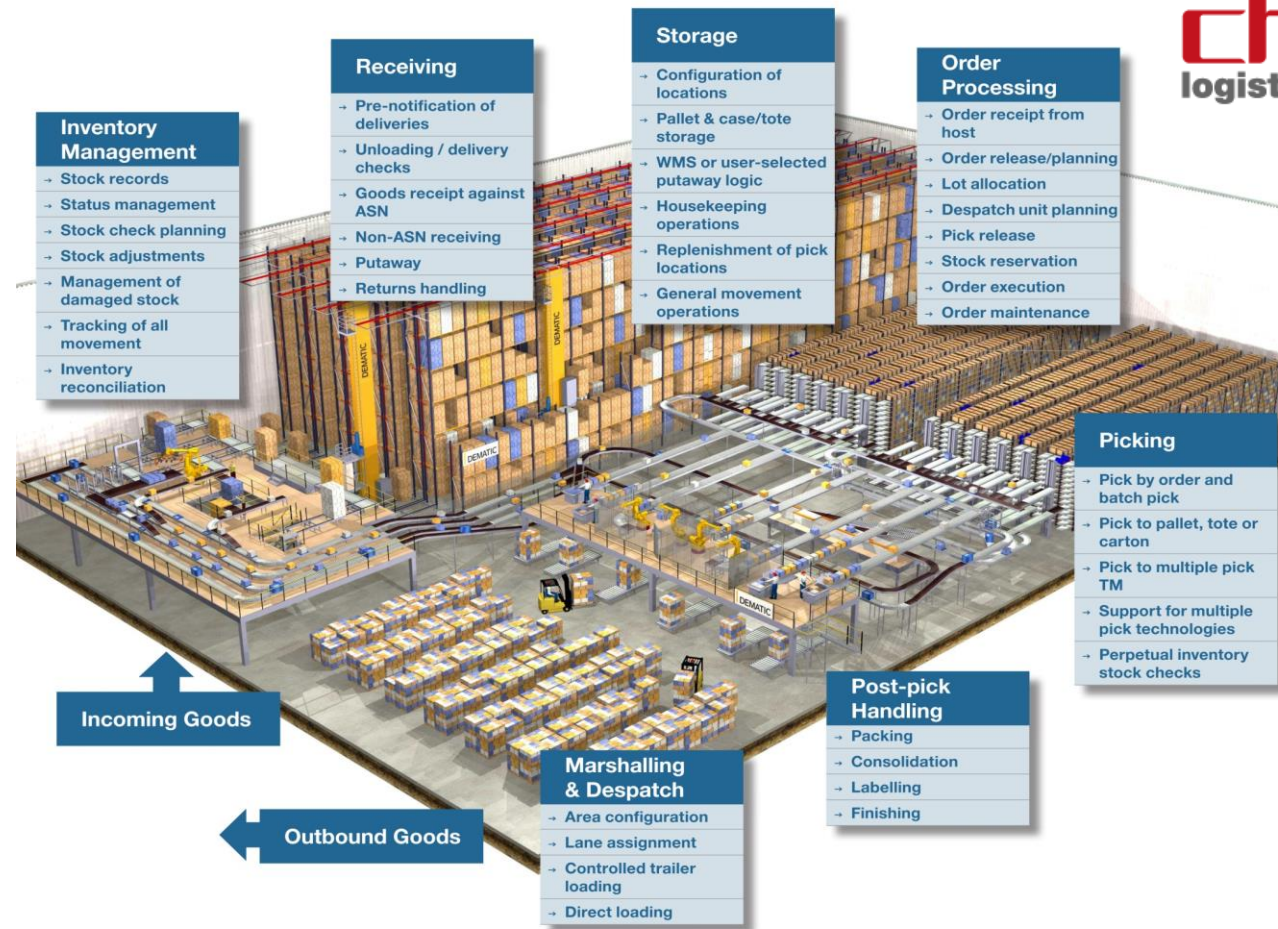

Warehouse Management Systems will provide:

Improved Accuracy, Productivity & Traceability

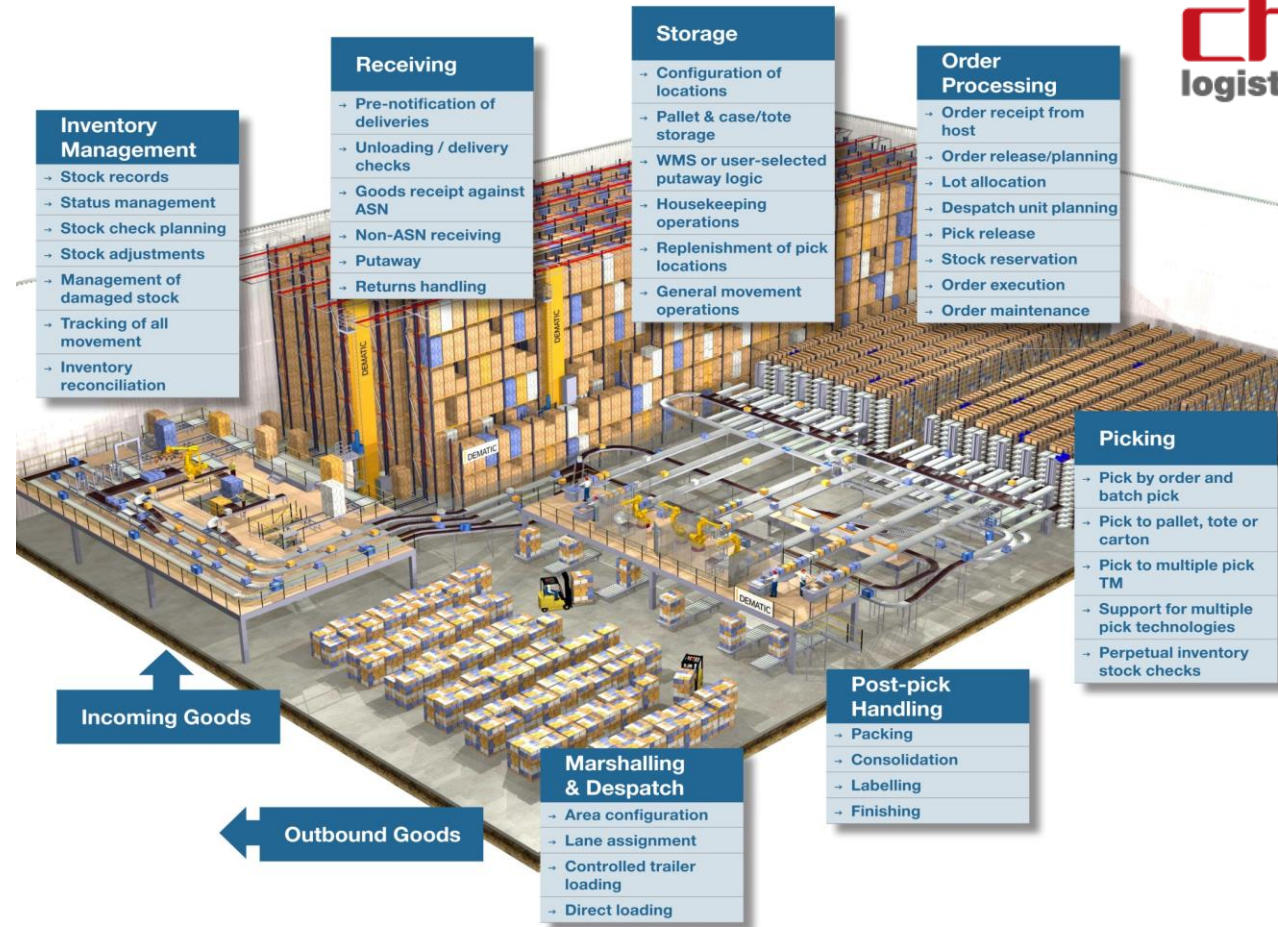

What's Involved?

Change to find new technology & work.

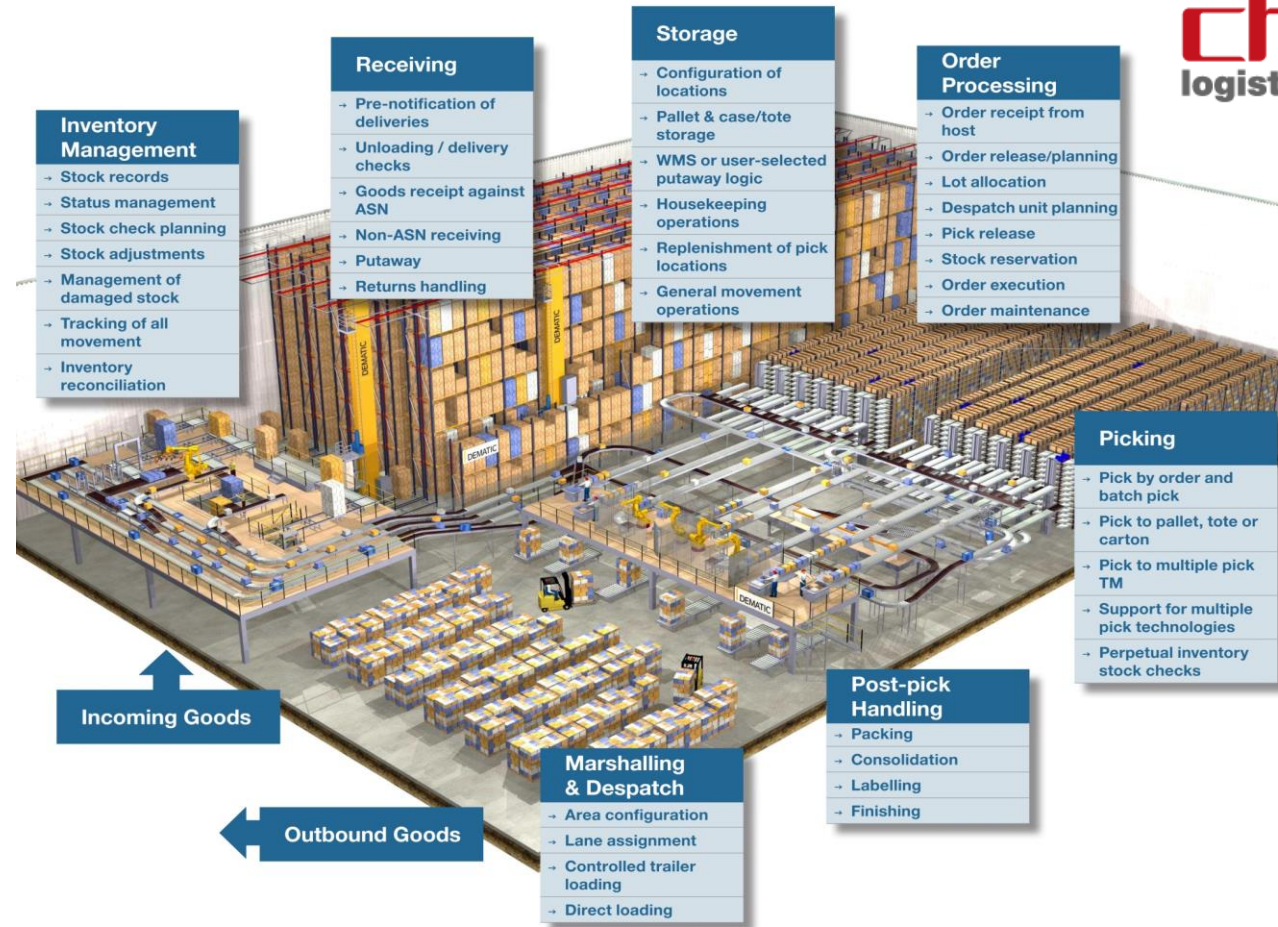

Also:

It's difficult to integrate with other systems in the business.

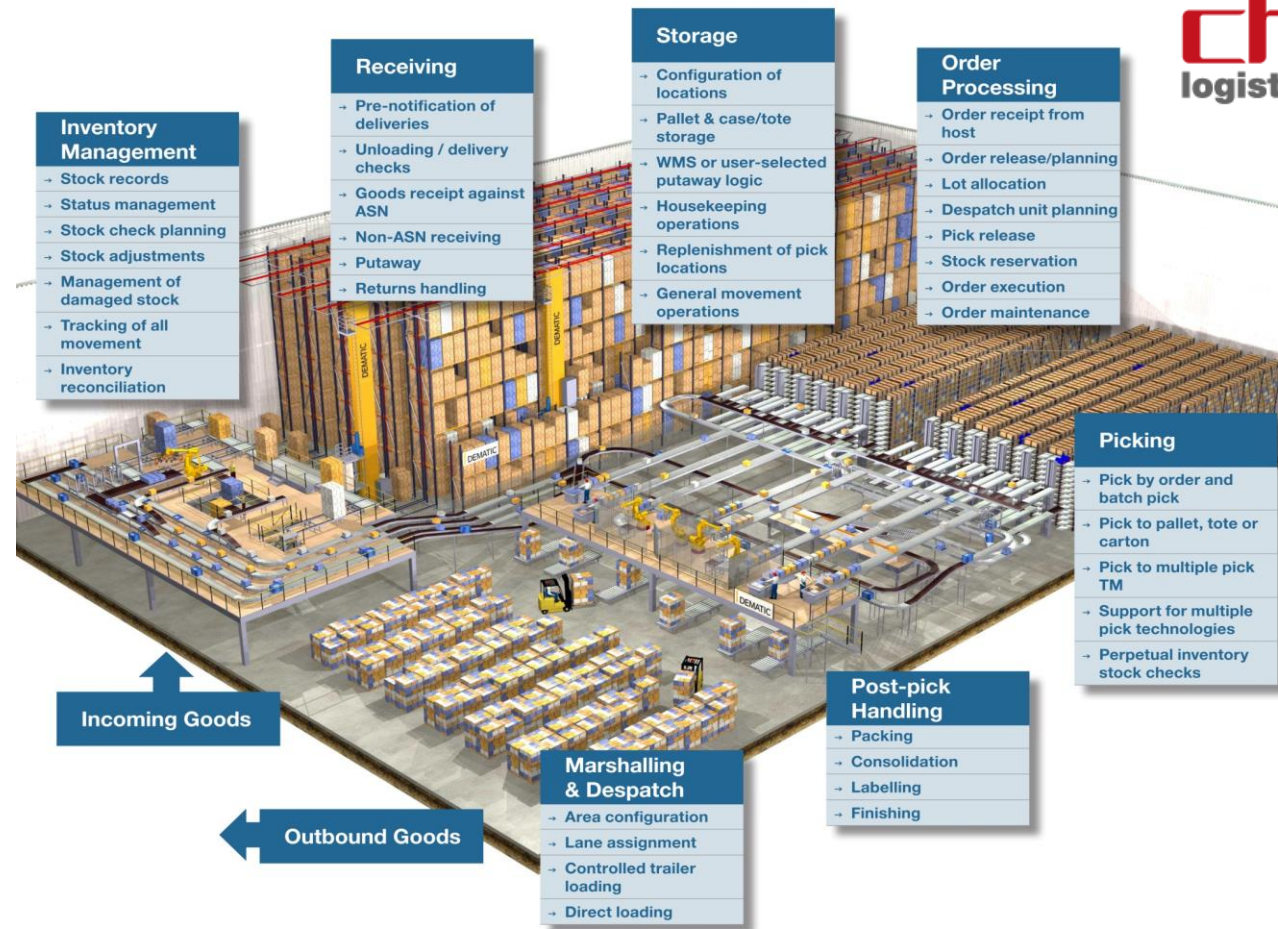

When implementing a WMS:

Designing the system (flow, ever refine, move & innovate)

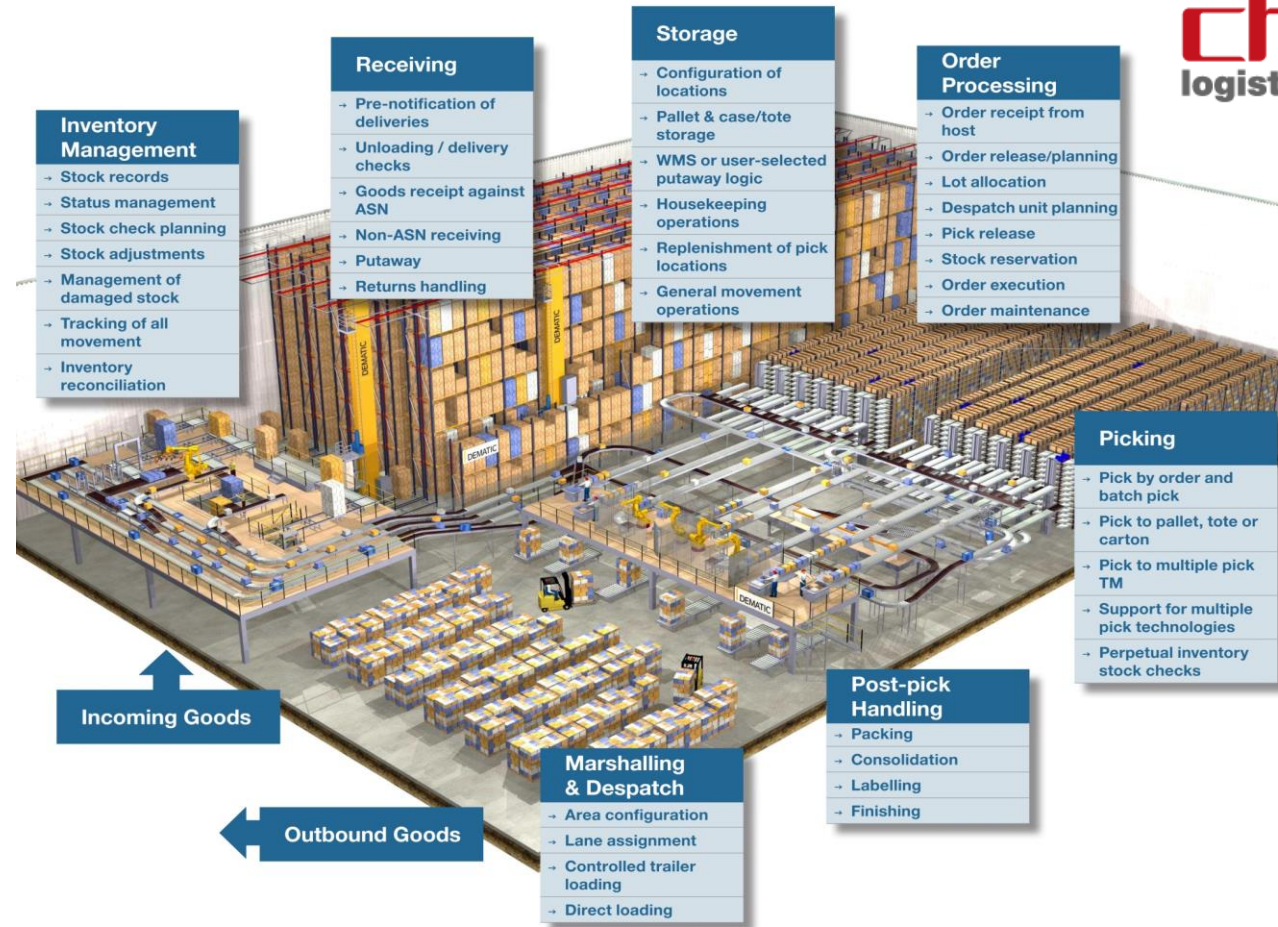

There's a lot to consider. Success will be worth it!

Key themes in designing the dream warehouse

- **Understanding your processes**
- **Data, data and more data**
- **Planning**
- **Prepare to invest in the time required**
- **Involving the wider business**
- **Understanding the options and suppliers**
- **Understanding your customer**

Get in touch...

 john.hayward@hatmill.co.uk

 07734 414 953

 www.hatmill.co.uk

This publication has been prepared for general guidance on matters of interest only, and does not constitute professional advice. You should not act upon the information contained in this publication without obtaining specific professional advice. No representation or warranty (express or implied) is given as to the accuracy or completeness of the information contained in this publication, and, to the extent permitted by law, Hatmill Ltd, its members, employees and agents accept no liability, and disclaim all responsibility, for the consequences of you or anyone else acting, or refraining to act, in reliance on the information contained in this publication or for any decision based on it.

© 2015 Hatmill Limited. All rights reserved. 'Hatmill' refers to Hatmill Limited.